

The new series KM 04 is the result of many years experience in designing and manufacturing rotators with a proven performance record. Powerful torque and consistent RPMs are the outstanding features of this superior gear driven rotator principally suitable for all types of operation.

KINSHOFER

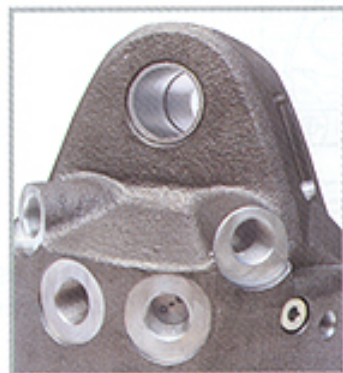

Designers with many years of experience, carefully chosen materials, latest state-of-the-art manufacturing equipment and stringent quality control assures long-lasting, trouble-free performance. The distinct braking effect, typical of a gear driven rotator when relieved from pressure, allows precise positioning. The unlimited angle of rotation and the precisely built control valves allow KINSHOFER rotators protection against overload and braking moments.



The gear-type rotator ensures permanent high torque and constant low RPMs even with high oil temperature. This is a definite advantage when compared to other designs.

A sturdy shaft and two tapered roller bearings safely support the rated tension load and tilting moment. KINSHOFER rotators are available either with forged flanged shaft or pin shaft of various diameters.

A solid rotator head with wear-resistant steel bushing is responsible for the reliable connection between plant equipment and rotator.

Rotator with pin connection - Continuous rotation. Easy change capability for various attachments. For operation with brick stack grapples, crane forks and clamshell buckets.

KM 04 S

Rotator with flange shaft, offering permanent connection to the attachment shaft. Robust solution for brick stack grapples, clamshell buckets, timber grabs, polyp grabs and similar attachments. Please consider the recommendation to the various attachments. For operation on plant equipment up to 7,5 tons operating weight.

KM 04 F

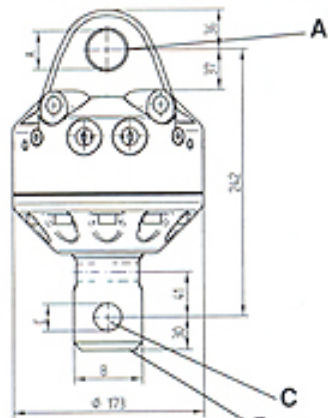

Rotator KM 04 S

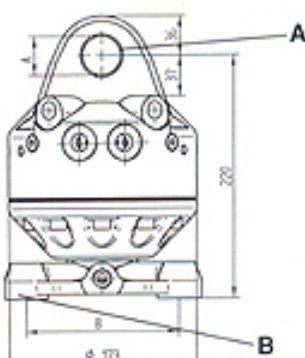

Rotator KM 04 F

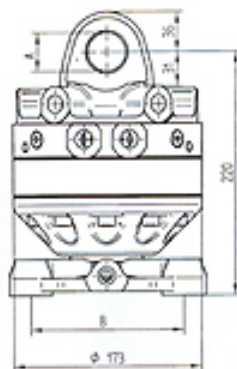

KM 04 F140-30S
Reinforced version for heavy duty operation

Rotator with pin connection

Type	upper connection dims (A) (inch)	lower connection dims (B) shaft diam. (inch)	lower fitting pin (C) diam. (inch)	torque max. (ft.lb)	allow. moment of deflection (ft.lb)	weight (lbs)
KM 04 S	3,30x1,18	2,44	0,98	626	2170	60
KM 04 S63-30	3,30x1,18	2,48	1,18	626	2170	60
KM 04 S68-30	3,30x1,18	2,67	1,18	626	2170	60
KM 04 S69-30	3,30x1,18	2,71	1,18	626	2170	60
KM 04 S68-30S ①	3,30x1,18	2,67	1,18	626	2170	60

Reduction link required

Rotator with flange shaft

Type	upper connection dims (A) width x pin diam. (mm)	lower connection dims (B) shaft diam. (mm)	torque max. (ft.lb)	allow. moment of deflection (ft.lb)	weight (lbs)
KM 04 F	3,30x1,18	□ 5,51 4x0,66	626	2170	60
KM 04 F140-30S ①	3,30x1,18	□ 5,51 4x0,66	626	2170	60
KM 04 F140-30V ②	3,30x1,18	□ 5,51 4x0,71	626	2170	60

① special edition for heavy duty operation (forged steel rotator head)
② model with additional vertical oil passages (refer to drawing)

Hydraulic connections

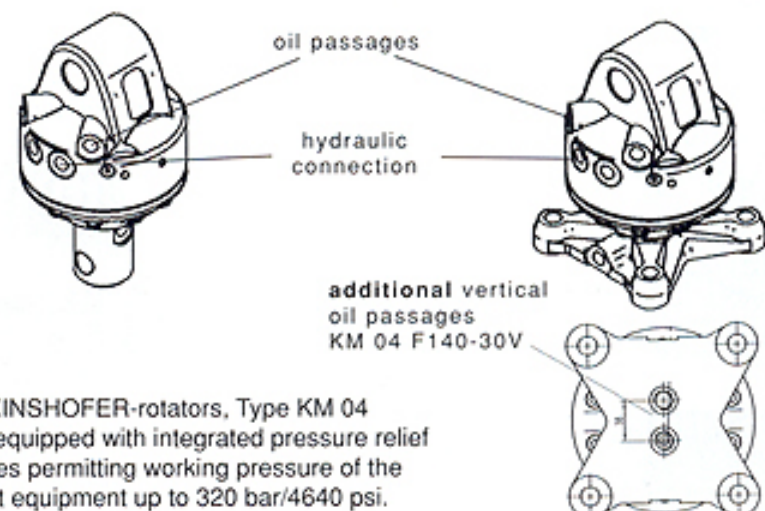

All KINSHOFER-rotators, Type KM 04 are equipped with integrated pressure relief valves permitting working pressure of the plant equipment up to 320 bar/4640 psi.